

Why did we choose this PLACE...



**Most people visit
the palace...**



**Some will walk to
Japanese garden...**

Moving through the history...

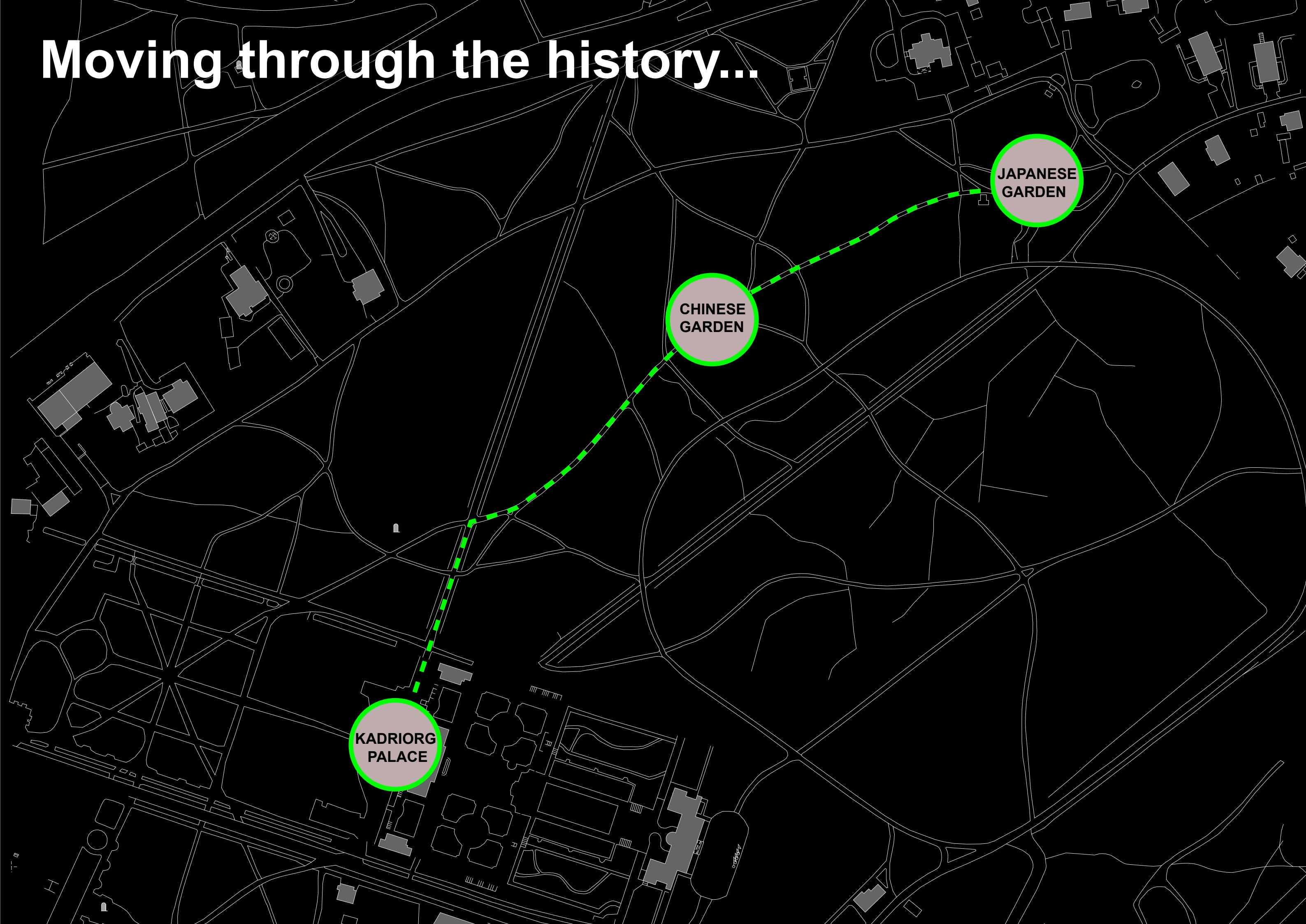



Boulders field

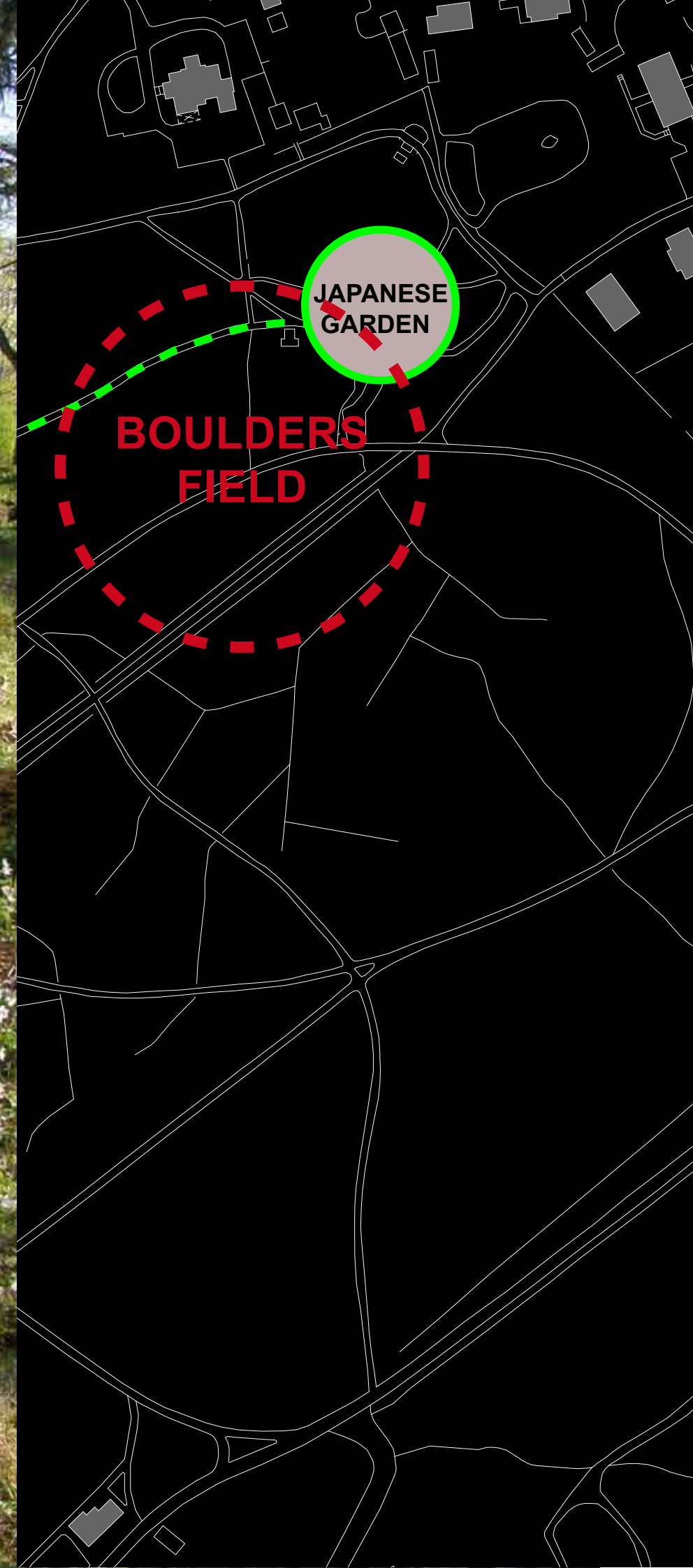



The **stones** - used to mark sacred places

The Importance of Location on land site



<http://lib.rus.ec/b/165607/read>



...facing and sitting directions

Yin(not active, sitting) and
Yang (active,facing)



Quite open view with sea...



Feng shui means 'wind' and 'water' - and looks at how these vital 'forces' or 'energies' run through a garden.

There must be a balance in the garden, to create the harmony of the garden.

The slope...



The Balance of the 5 elements

The Wood produces Fire, the Fire produces Earth, the Earth produces Metal, the Metal produces Water and the Water produces Wood. The Five elements are actually five different energies or types of energy. The expression “Wood produces Water” is actually describing an energy transformation. It is of uttermost importance to understand that the five elements always strive to attain balance, and it is through the five elements that the Yin and Yang balance is achieved.



Park development guidelines to 2018

12. ETAPP	2015	
12-1	2015	Pillapalu platsi puistu uuendamine - 6,0 ha.
13. ETAPP	2016	
13-1	2016	Tammesalu puistu uuendamine - 8,0 ha.
4. ETAPP	2017	
14-1	2017	Limneamere astangu puistu uuendamine - 3,8 ha.

....cut and replant trees



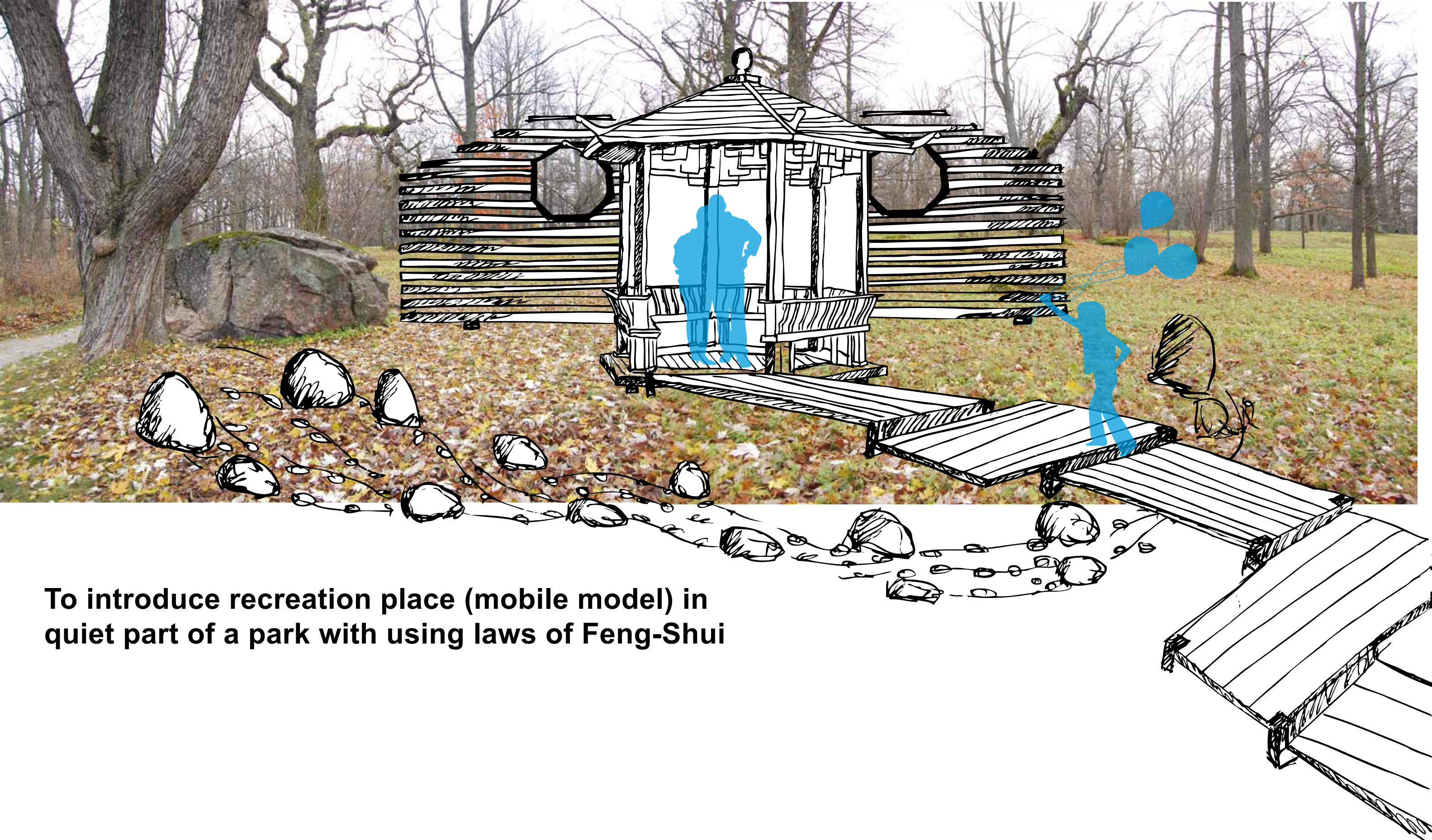

To introduce recreation place (mobile model) in quiet part of a park with using laws of Feng-Shui

Nature and Symbolism are both important themes of Chinese garden design...

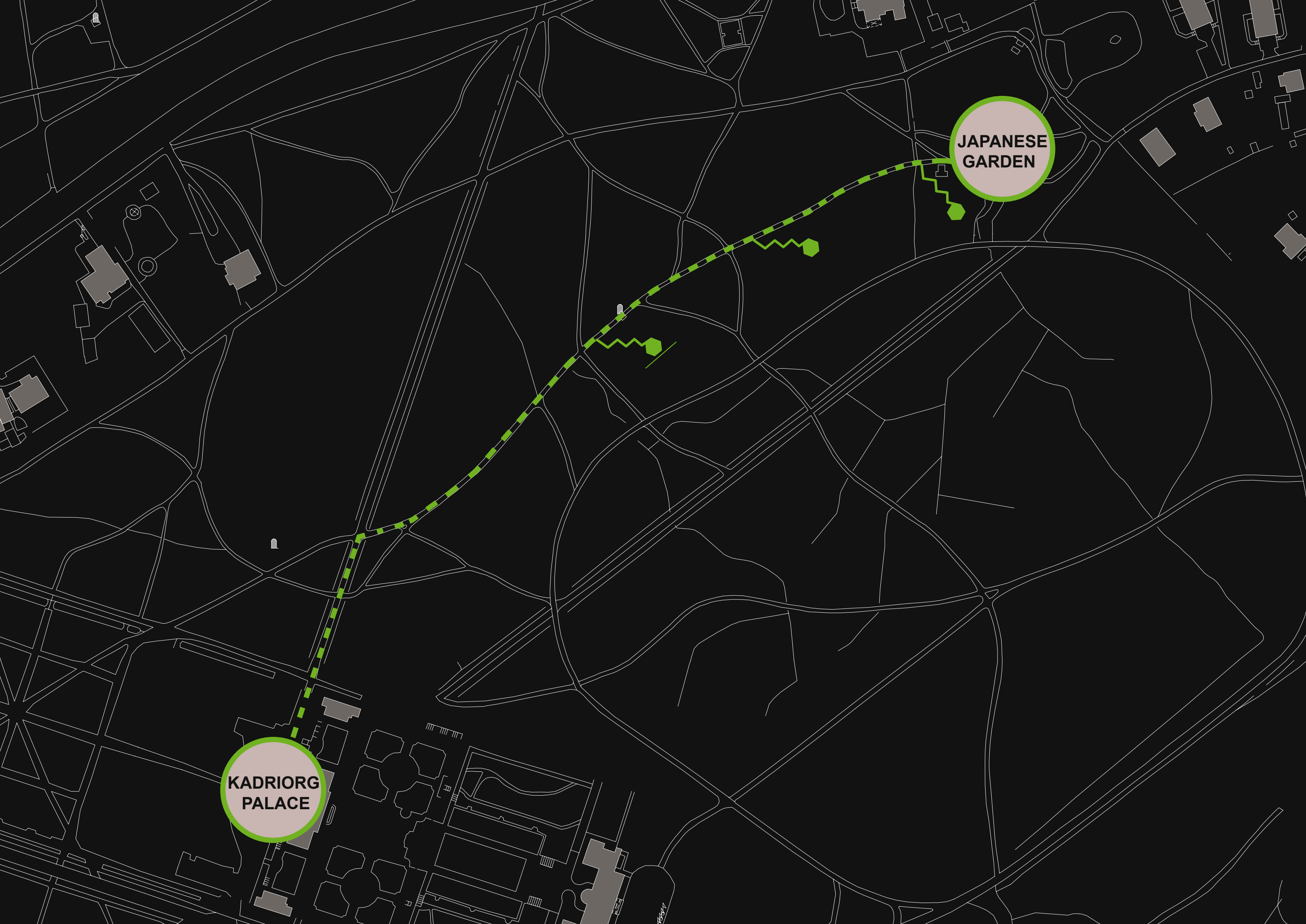

KADRIORG
PALACE

JAPANESE
GARDEN



garden-existing trees and stones
elements- wall, pavilion and zigzag bridge
elements are mobile and could be changed position of it location



Wall with openings – to frame the view



<http://www.eazywallz.com/products/White-wooden-fence.html>



http://1.bp.blogspot.com/_2QVtn1DXgwU/7RZafagOvIAAAAAAAAAADhs/DK335y62ZbU/s1600/MG_9098-a+copy.jpg

The correct flow of life energy - zigzag bridge

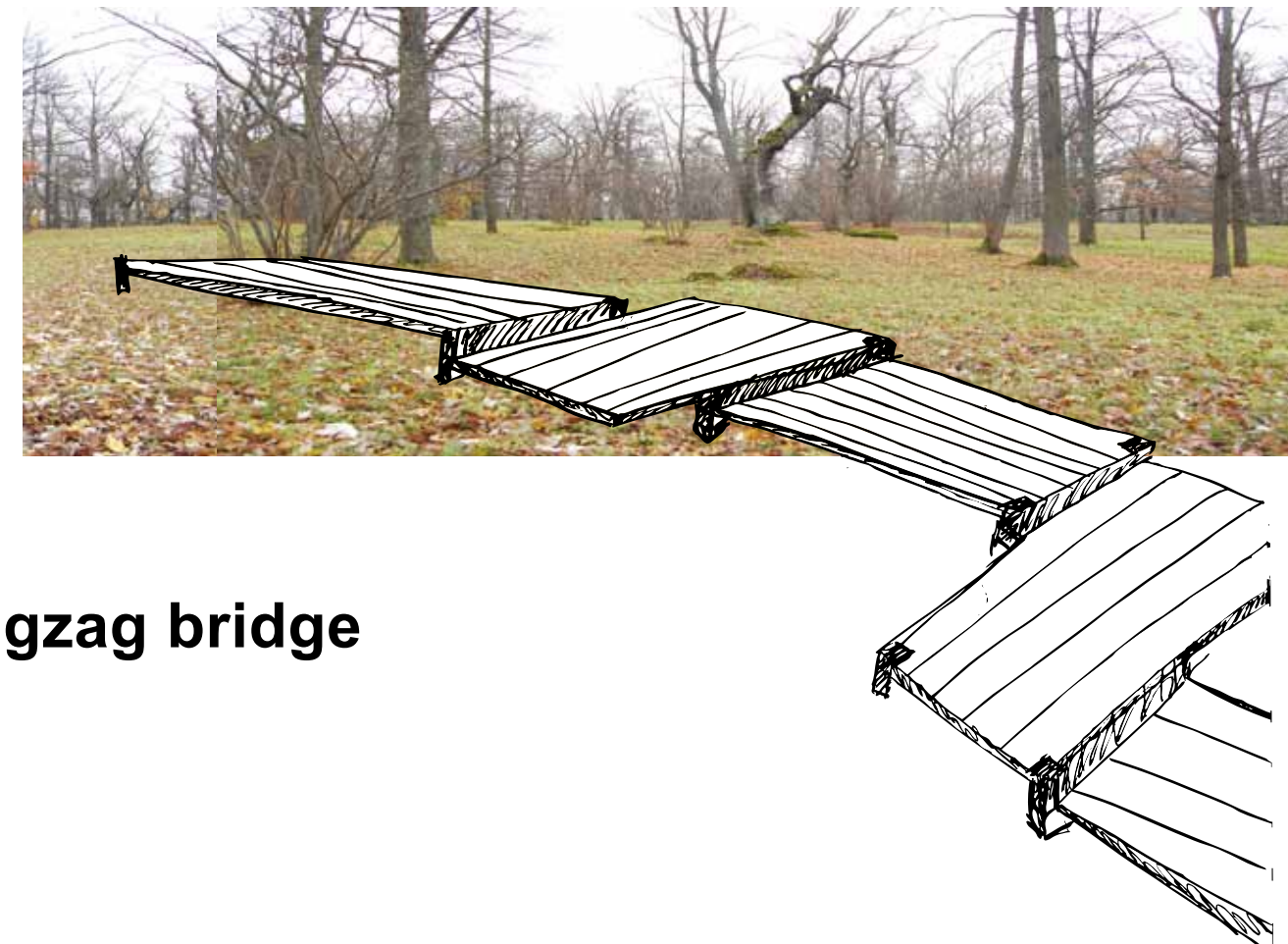
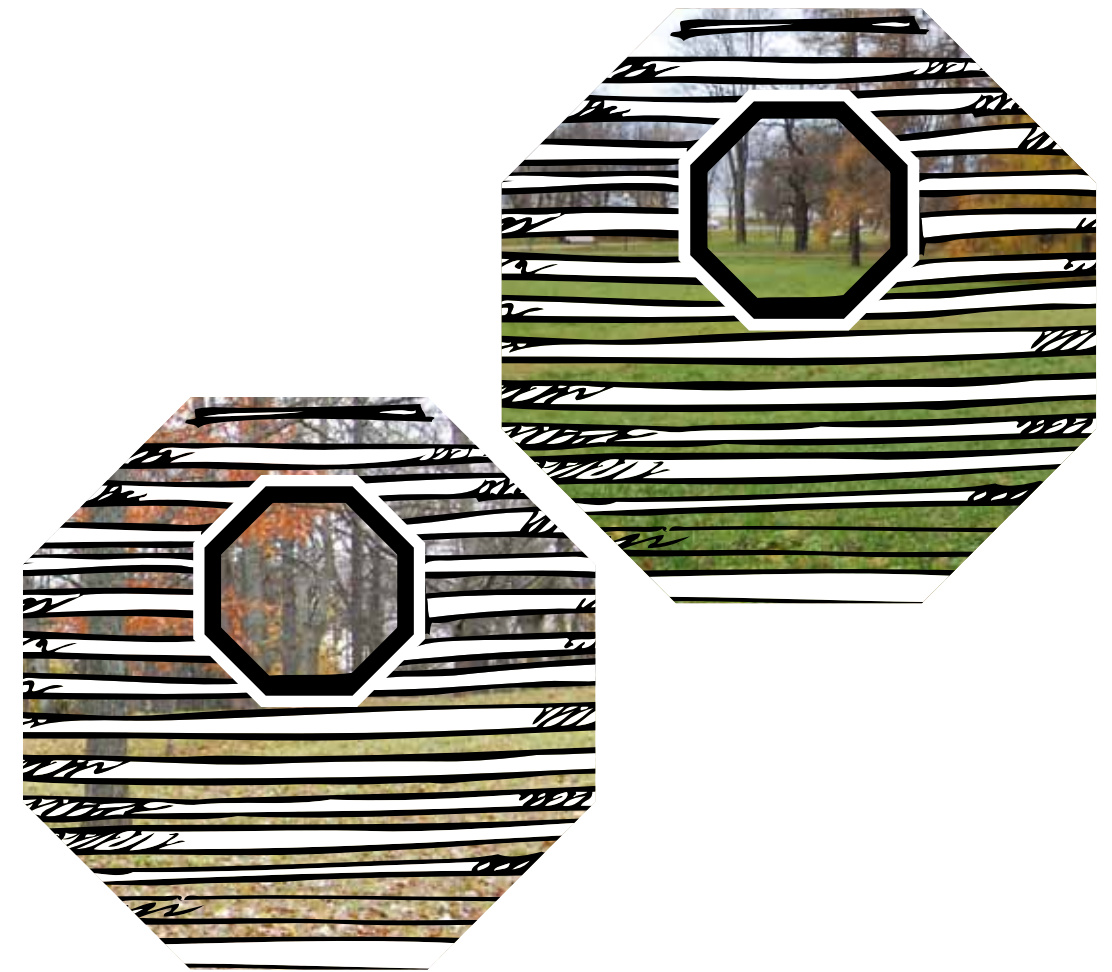

Seclusion – pavilion



<http://www.eazywallz.com/products/White-wooden-fence.html>

...recreation, meditation, tea ceremony,
observing surroundings

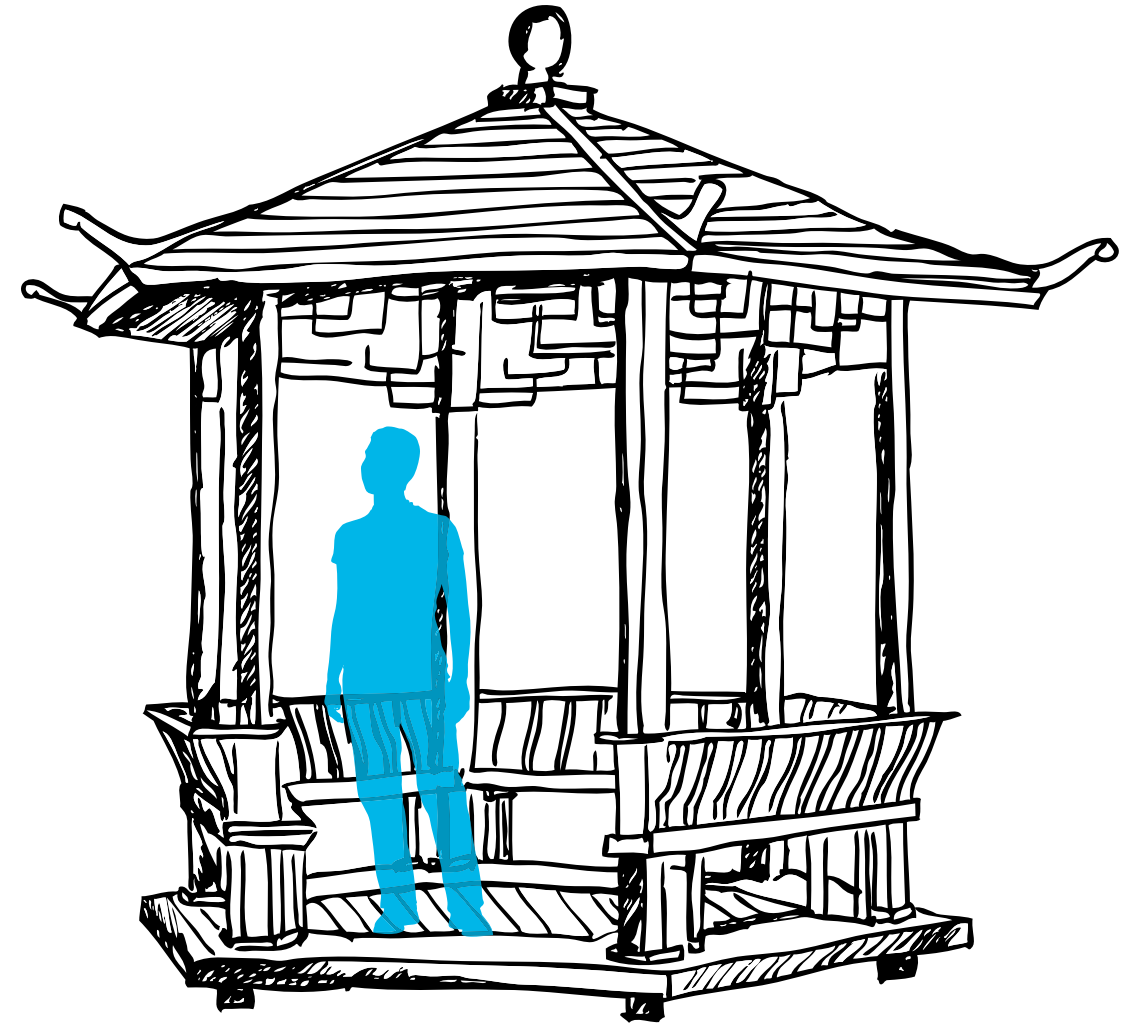

Sand river - existing stones, part for imagine

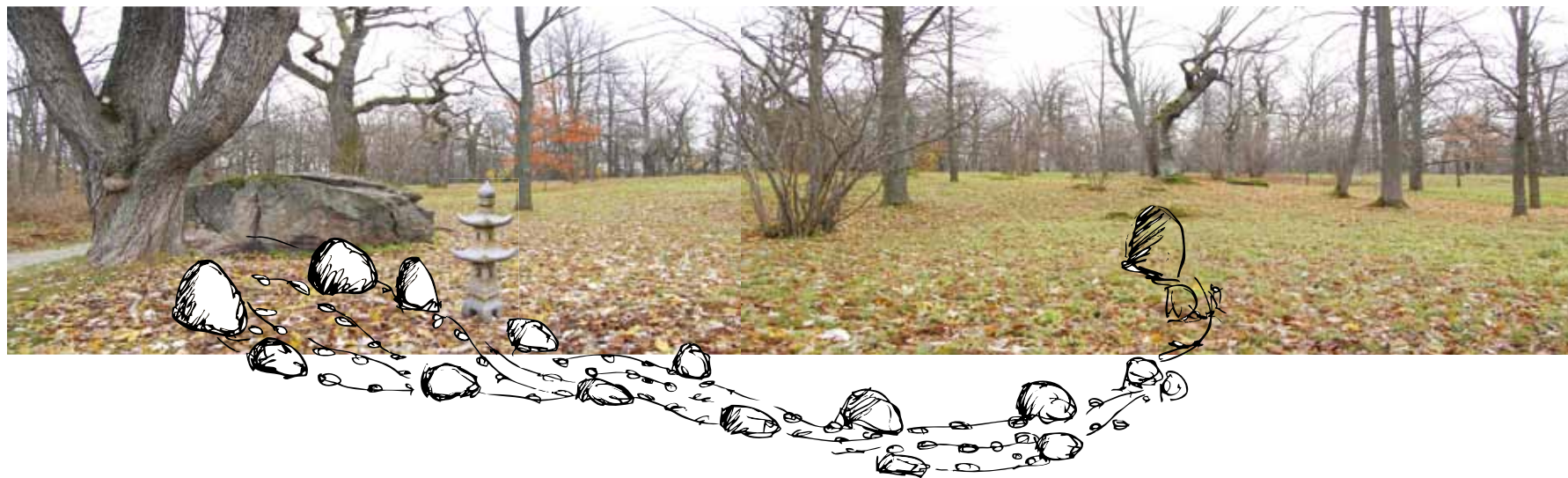



<http://marrayhotel.foss4sme.ch/wordpress-mu/wp-content/blogs.dir/125/files/do-u-know-chinese-tea/chinese-tea-longjing-52.jpg>

...tea ceremony

Thank you!



http://farm4.static.flickr.com/3536/3222691473_61121bbd50.jpg

Chinese New Year in Kadriorg park

**Rebecca Kontus
Viktoria Ivanova**

Tallinn 2011